

ESTATE AGENTS



Farr & Farr

farrandfarr.co.uk

PRICE: £132,500

REF: LG24208/JF

**100 CASTLEMEADS COURT
WESTGATE STREET
GLOUCESTER
GL1 2PA**



**A STYLISH FOURTH FLOOR APARTMENT IN A SOUGHT AFTER
RETIREMENT COMPLEX**

City Centre:

2a Worcester Street
Gloucester GL1 3AA
☎ 01452 500025
✉ office@
farr-farr.co.uk

Hucclecote:

50 Hucclecote Road
Gloucester GL3 3RT
☎ 01452 613355
✉ hucclecote@
farr-farr.co.uk

Longlevens:

125 Cheltenham Road
Gloucester GL2 0JQ
☎ 01452 380444
✉ longlevens@
farr-farr.co.uk

Churchdown:

1 Church Road
Gloucester GL3 2ER
☎ 01452 857421
✉ churchdown@
farr-farr.co.uk

Lettings:

40 Oxstalls Way
Gloucester GL2 0JQ
☎ 01452 238298
✉ lettings@
farr-farr.co.uk

100 CASTLEMEADS COURT, WESTGATE STREET, GLOUCESTER

Castlemeads Court is a secure retirement complex designed for people of 55 years and above. It enjoys the benefits of a communal lounge, gardens, and laundry area.

100 Castlemeads Court has been beautifully upgraded in its current ownership and now offers a modern and contemporary feel. The property benefits from two double bedrooms, living/dining room, refurbished kitchen, and newly fitted bathroom.

TWO BEDROOMS: LIVING/DINING ROOM: KITCHEN: NEWLY FITTED BATHROOM: VIDEO ENTRY SYSTEM: SHARED SECURE PARKING: RESIDENTS LOUNGE: LAUNDRY ROOM: NEWLY CARPETED AND DECORATED THROUGHOUT:

Front door leading to:-

ENTRANCE HALL:

Carpet. Two storage cupboards.
Intercom. Door to:-



LOUNGE/DINER: 16'4 x 11'3.

Double glazed window. Electric fireplace. Carpet. Storage heater. T.V point.





Double doors leading to:-

KITCHEN: 8'4 x 5'9.

A range of wall and base units. Integrated single Neff oven. Four ring induction hob with extractor above. Custom single sink and drainer with mixer tap. Space for fridge and freezer. Newly tiled splashback.



BEDROOM 1: 16'6 x 9'4.

Double glazed window. Storage heater. Carpet. Built in mirror fronted wardrobes.



BEDROOM 2: 18'6 x 8'8.

Double glazed window. Storage heater. Newly fitted custom built wardrobe.



BATHROOM:

Newly fitted fully tiled bathroom with white panelled bath and overhead shower. Vanity unit with basin. Mirrored cabinet. Low level W.C. Marble tiled flooring.





(View)

EPC: C-80

AGENTS NOTE:

All measurements are approximate

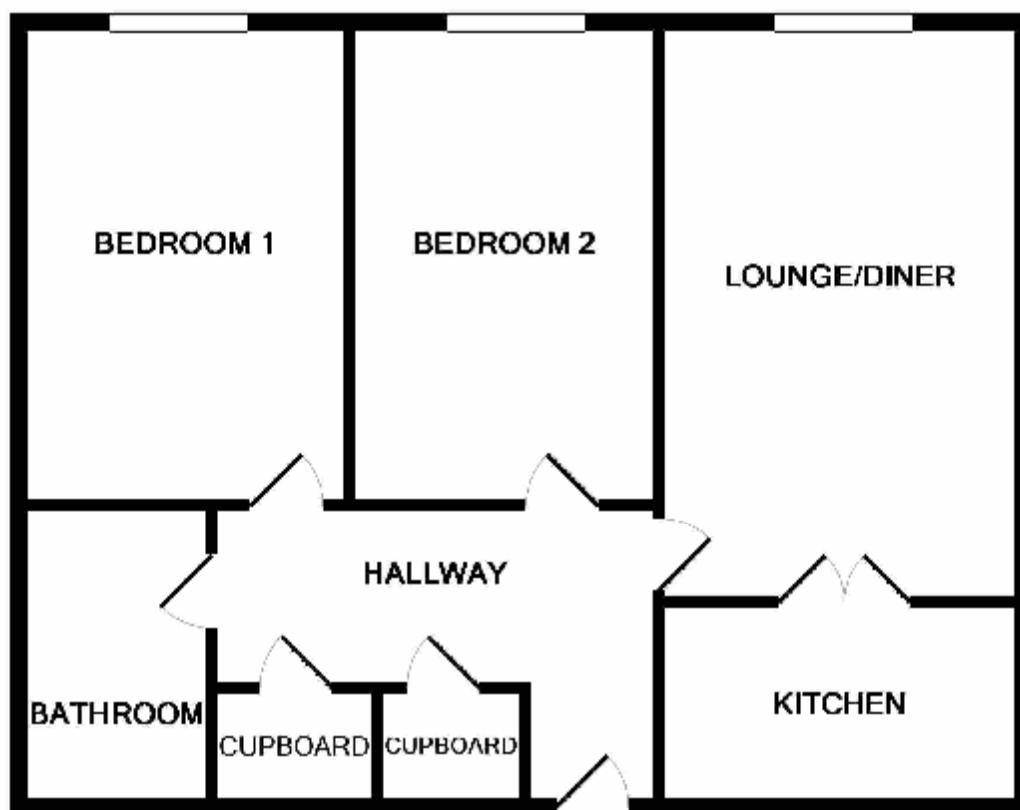

TOTAL APPROX. FLOOR AREA 624 SQ.FT. (57.9 SQ.M.)

Whilst every attempt has been made to ensure the accuracy of the floor plan contained here, measurements of doors, windows, rooms and any other items are approximate and no responsibility is taken for any error, omission, or mis-statement. This plan is for illustrative purposes only and should be used as such by any prospective purchaser. The services, systems and appliances shown have not been tested and no guarantee as to their operability or efficiency can be given.

Made with Metropix ©2019

VIEWING STRICTLY BY APPOINTMENT THROUGH THE AGENT